

A HISTORICAL STUDY ON THE PARCEL NUMBER AND NUMBERING SYSTEM IN KOREA

Prof. Uknam KIM, Korea

Key word: land registration, parcel number, numbering system, Land Information System, cadastral history, reform reestablishment.

ABSTRACT

Among legal unit of land registration, the minimum unit of land is one parcel. We give the parcel number according to numbering system to confirm the specification of the parcel. In Korea, this parcel number is used for daily life such as the sign of fixed place(address) and the property, of the place of register, of identification card and of legal action.

It also plays the important role as a key item connecting the layer of other information system in organizing Land Information System. It is also valued as the sources looking for the process of developing of the country.

This study will devote to cadastral history, reform and reestablishment of the country.

1. INTRODUCTION

1.1. Purpose

The land information system(LIS) which records and manages the land-related informations has been developed for the effective use and management of the land.

By connecting each parcel on the surface of the earth in the modern city, better service for all kinds of infrastructure utilities (water supply, drainage, electricity, gas, communications, roads) should be quickly offered to the final users.

As the efficient conduct of the works above is considered as an important official duty in the urban administration, the officials should make the most of LIS for the information exchange among the relevant sections, for the systematic conduct with better performance, for the integrated data management which is based on the digital and time-serial process.

Having the technology of urban information system, LIS holds cadastral information, resident information, building information, road information, etc. These informations are connected with a parcel which is the minimum unit of the land. Each parcel is specified by its own number so named "parcel number".

Parcel number with a sub number, in case of the occurrence of boundary trouble, has a role to choose the basic point for the survey on the map by distinguishing between the history of the divided land and the line on the cadastral records.

Parcel number is the minimum unit by the work of land administration. If parcel number is logically managed, it plays a important role to relate text with graphic data, such as a primary key in database.

This paper describes the form of the parcel number and the numbering system in Korea with the change of the times and offers the sources to establish the best possible model

of the numbering system.

1.2. Study scope and method

The Korea government has already completed the pilot project of cadastral re-survey and is now in preparation for legislative bill which includes the registering of buildings and underground facilities with parcel based in the six metropolitan cities from 2010 through the new system of parcel number.

For offering the sources to national policy of land management, this study analyzes the change of the parcel number and its granting system in Korea and set the scope as follows.

Chapter . presents the purpose, scope and the method of the study as an introduction, chapter. describes the parcel number and its granting system, chapter. analyzes the change of the parcel number form and the system. Chapter . presents the sources for the model selection of the best possible parcel number and its system in Korea according to the result of the analysis.

2. GENERAL VIEW ON THE PARCEL NUMBER AND ITS SYSTEM

2.1. Definition of the parcel number

The parcel number is a particular number allotted to a unit area to guarantee the particularity of the land and is a number given to each parcel as a registration unit.

Every trade of the land is guaranteed only after the allowance of the parcel number. The most important reason to grant the parcel number is to distinguish the land and then to guess the location.

The concept of an address used in everyday life is called as a lot number, but the parcel number has a role as a standard for communications, visitations and administration with the meaning of the particular location of the land. Therefore, the parcel number of the land has to be granted orderly and systematically for more convenient use.

2.2. Constituent element and type of the parcel number

The parcel number is consisted of an original which is the particular number given to a unit area without a sub number such as 1, 2, 3, . and a sub number which is a new title defined at the cadastral law with the enforcement of May 7, 1976 earlier called as branch number or attached number. The sub number is written as -1, -2, -3, . and read as "dash one", "dash two", "dash three", etc. So, the parcel number is consisted of an original number only or at other times an original number with a sub number but it is not possible to make a parcel number with a sub number only. The parcel number with an original number only is called as "single parcel number", and the parcel number with an original number and a sub number is called as "double parcel number".

The single parcel number is suitable for the large land and has been used both in the land survey and the forest survey in Korea. Also it is often used in the country which tries to establish a new cadastral system. The double parcel number is used for the parcels of new registered land and the divided land, and highly beneficial for the complex unit law.

2.3. Standard of the parcel numbering

(1) Principle of parcel numbering

The parcel number as a unit of parcel number area is established on the principle of the northwest numbering rule orderly starting from number 1 by the direction of northwest to southwest. (Enforcement ordinance of Cadastral Law, Article 3 clause 1)

(2) Numbering due to an initial registration and so on

It is established by attachment of a sub number such as -1, -2, -3, etc. to the nearest original number of a registered land in the relevant parcel number area in the case of initial registration, registration conversion, parcel number change, administration area change, etc., or an original number will be orderly established from the next to the last parcel number of the relevant parcel number area in the case of a remote land, the last parcel number in the relevant parcel number area, several parcels and vast area. (Enforcement ordinance Cadastral Law, Article 3-2, -6, Enforcement regulation of cadastral Law Article 4-2)

(3) Numbering due to partition

1) The one parcel divided of a parcels is numbered by the same parcel number as before partition and the other parcels are numbered by attaching the sub number to an original number which is the parcel number before partition as like (figure 1).

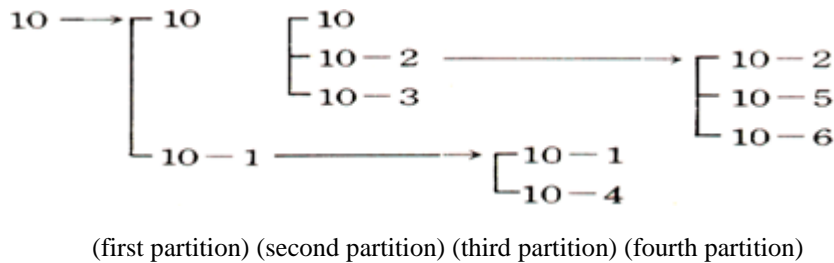

Figure 1. Numbering system after partition

2) If the land owner applies by designating a certain parcel after partition as the particular number, the parcel which the owner wants can be numbered as (figure 2) after examining the reason. (Enforcement ordinance of Cadastral Law, Article 3-3)

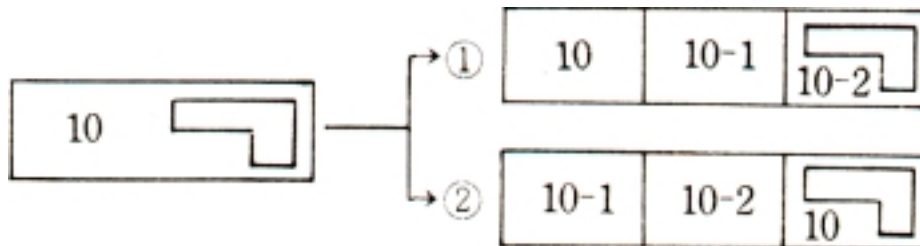

Figure 2. particular numbering system after partition

The parcel number after partition should be granted like . in figure 2, but it can be given like . in (figure 2) when the owner wants to grant the parcel number to the land of residential building after partition according to the address number 10.

(4) Numbering due to affiliation

The front parcel number among the parcel numbers before affiliation can be granted like <table 1> or the prior parcel number which is an original number among the parcel numbers before affiliation is granted like <table 2>. When the land owner applies by designating the particular parcel number among the parcel numbers before affiliation, the parcel number which the owner wants can be numbered like (figure 3) after examining the reason. (Enforcement ordinance of Cadastral Law, Article 3-4)

<Table 1> prior numbering system after affiliation

parcel number before affiliation	parcel number after affiliation
3	3
6	3
6-1	3
10-5	3
101	101
103	101
110-1	101
101-2	101

The parcel number after affiliation should be granted as address number 1, but the same address number (the parcel number in which the building was constructed) can be granted when the land owner wants.

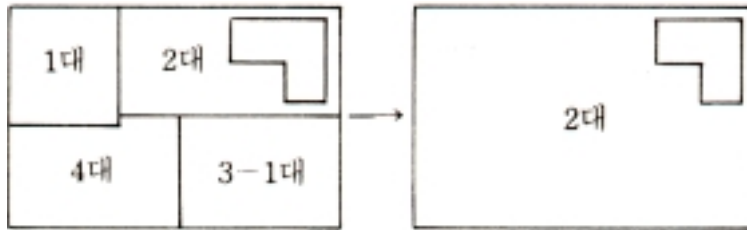

Figure 3. particular numbering system after affiliation

<Table 2> prior numbering system as an original number after affiliation

parcel number before affiliation	parcel number after affiliation
3-2	4
4	4
5-1	4
5-2	4
6	4
100-3	105
100-4	105
105	105
107	105
110	105

(5) Parcel numbering according to the land readjustment and so on

- 1) The original number will be established from the previous parcel numbers assigned to the project enforcement area, which is consisted of an original number only or an original number with a sub number.
- 2) In case the previous parcel number assigned is less than a new parcel number, an original number with a sub number will be established or an original number will be granted to each block unit and each parcel will be granted the original number with a sub number.
- 3) In case of the project to prepare a housing site, the same original number will be granted according to the progress direction of the main roads and each parcel will be numbered by the original number with a sub number. (Enforcement ordinance of Cadastral Law, Article 3-5)
- 4) In case the previous original number is stretched over the border of the project enforcement area, the original number will not be used. (Enforcement ordinance of Cadastral Law, Article 4-4)

2.4. Method of parcel numbering

(1) Classification according to the progress direction

1) Meandering method

This method is granted to the area which is the parcel arrangement is not regular and the original number is continued in order according to the progress direction. It is suitable to establish the parcel number in the rural area.

2) Odd and even numbering method

The odd number will be granted to one side of the road and even number to the other side. It is also called the reciprocal method and is suitable for granting the parcel number in the urban area.



Figure 4. meandering method



Figure 5. odd and even numbering method

3) Block method

One original number will be granted to each block and one sub number to each parcel in the block. It is suitable for granting the parcel number in the land readjustment area, the cultivated area and so on.

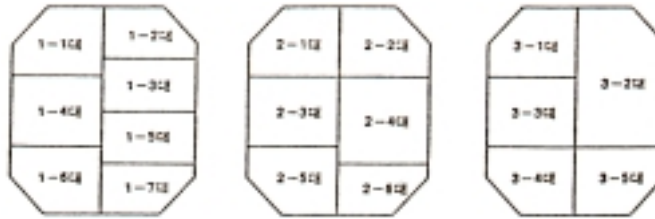

Figure 6. block method

(2) Classification according to the unit established

1) Area unit method

This method is to grant the parcel number in order for the whole area of one parcel number. It is suitable for the small area of one parcel number or the area which does not have many sheets of the cadastral or forest map.

2) Map unit method

One area is subdivided into cadastral map unit or the forest map. The parcel number will be granted in order according to the order of map. It is suitable for the large area or the area which has many sheets of the cadastral or forest map.

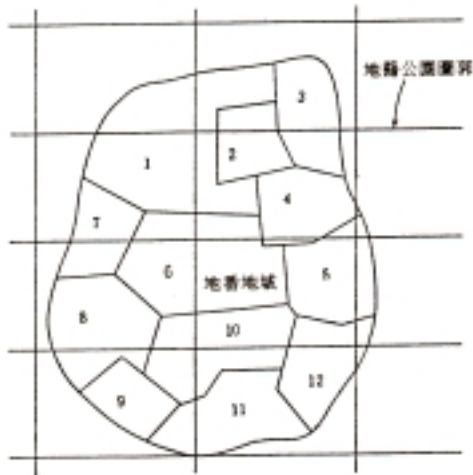

Figure 7. area unit method

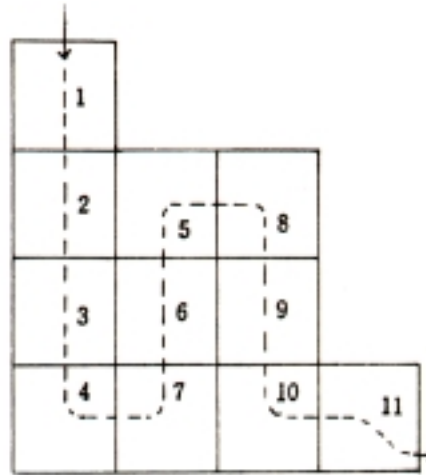

Figure 8. map unit method

3) Block unit method

The parcel number is granted orderly to the whole area of one parcel number. It is suitable for the small area or the area which does not have many sheets of the cadastral or forest map.

(3) Classification according to the numbering location

1) Northeast numbering method

This method is numbering from northeast to southwest in order and is suitable to establish the parcel number in Chinese characters.

2) northwest numbering method

This method is numbering from northwest to southeast in order and is suitable to establish the parcel number in Arabic numerals.

2.5. Characteristics and roles of the parcel number

(1) Characteristics of the parcel number

The land indication should have the characteristics such as accuracy, simplicity, uniqueness, flexibility, economy and accessibility.

The land has the characters such as immovability of location, individuality and so on, and is subdivided into each parcel. The different number is given orderly to each parcel subdivided in each parcel number area and thus it has accuracy and uniqueness. Each parcel in the same parcel number area is given different numbers and thus it has accessibility to distinguish one parcel from the other. Each parcel is specified by the number assigned. Thus each parcel in each parcel number area is guaranteed to have specification by its parcel number and so the parcel number has the uniqueness.

In addition, because the parcel number may have the same number of the parcel number as the number of parcel number area without indication of the parcel number area, it is difficult to guarantee the uniqueness of each parcel by the parcel number without indication of the parcel number area. It also has simplicity and economy to divide and combine the parcel number area. Especially, in case of computerization of land registration, this discerning factor is called integration key.

(2) Roles of the parcel number

The location and the border of every land in Korea has been established by cadastral survey. The location of land is discerned by relative location in everyday life rather than absolute location concept by coordinate.

The relationship between human and location has many connections in law. The parcel number indicates the location of permanent domicile, resident registration domicile, present domicile, property location, place of an act, address, residence, office, place of business, etc. If there were not the parcel number, we would have a lot of troubles and problems in social and legal activities.

Thus the location of every land should be indicated clearly, and the form of the parcel number and numbering system should be established in proper way.

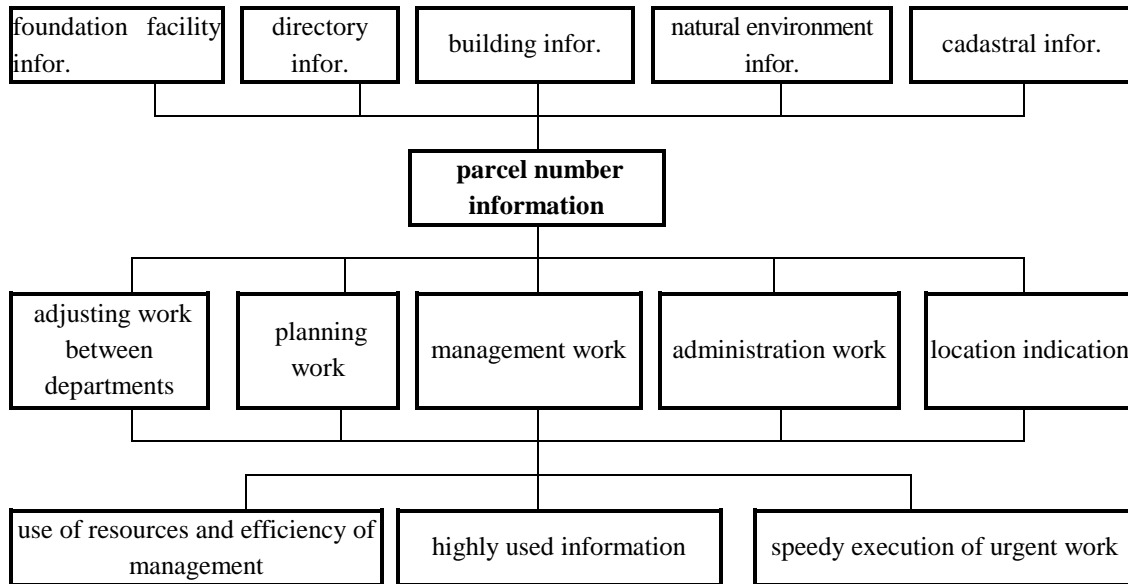

Figure 9. The concept of parcel identification number use for establishing the urban information system (The association of Japan Surveying Technology, 1989)

Land (forest) register, real estate register and land record computerization are also enforced according to each parcel number. The parcel number plays a role as common item or key item of each layer related to land in the use of computerized information for land information construction and multipurpose cadastral system.(Figure 9) is to analyze the possibility of materials and information exchange using the parcel number between U.I.S (urban information system) and other institutes. It is reasonable to record and indicate the items on land according to each parcel number. Thus the parcel number plays an important role to plan and enforce the land project.

3. CHANGE OF PARCEL NUMBER AND NUMBERING SYSTEM IN KOREA

In each period such as before land survey (1910), from land survey to 1960's, 1970's, after 1986, the form of parcel number and numbering system is classified and studied focusing on comparative analysis of standard to establish parcel number, parcel number composition, sub number area, sub number direction, land alternation.

3.1. Parcel number and numbering system before land survey(1910)

We can reach conclusion that there was no parcel number system because of no records on parcel number from ancient times to the middle of Koryo. By enforcement of Kwajeon Law at the end of Koryo, land register and parcel number (Ja ho) system had been started to establish to grasp the concrete condition of land.

Parcel number system was adopted at the period of King Gongyang(1345.1394) and by this, numbering system defined 'Jung' as land establishing area to classify every land within Jung up to one thousand Jung from Chonjajung, Jijajung to Yajajung in order of the Thousand-Character Text. Jung was divided into 20kyol, 15kyol, 10kyol, etc. according to military service condition, and land register was made by Jung unit and land owner's name was written after putting character & number to Jung. Later the form

of land register by Kwajeon Law became the turning point from the early or middle period's person centered arrangement to the material centered arrangement according to each parcel number (Ja ho) by Jung unit.

In Chosun period, character-number was granted to each parcel in order of the Thousand-Character Text according to the order of Yangjeon to indicate the condition of land.

Character-number was consisted of characters and numbers, and one character of the Thousand-Character Text was granted to per 5kyol regardless of Paekyungjeon, Kikyungjeon. It was the so-called 1 character 5kyol system. It was started to discuss from 24-year of King Injo(1569) and later it was enforced in full scale for the project of Haeseoyangjeon at 35-year of King Sukjong(1696).

The land was classified according to each owner by numbering No.1, No.2, No.3, etc. within one character of The Thousand-Character Text. Its character meant the area of land and was same with the area establishing parcel number, and its number was same with the present parcel number. In case land improved after character-number had been already granted by the enforcement of Yangjeon, the previous character-number in Yangankijae was used without change for its character-number. When there was a new land after Yangjeon branch number was attached to character-number of its adjacent land and so this means there was sub number system to establish parcel number in Chosun. At the end of Chosun, however, when Yangjeon official improved land, he could change the previous character-number. In this case, the reason to change character-number, that is, words such as old Chonja new Jija, etc. should be written in the column related to land in Yangan. Especially, in case the character distorted by deliberate change, land of new Joho could be checked by old character-number by comparison old with new Yangan.

For example, .table 5.is cited from No.14711 of old document Yangan in Kyujangkag.

Table 5. Kyungsang-do Namhae-hyun Kyungja Yangan improved (Sukjong 46 year-1720)

慶尙道 南海縣 庚子改量田案 <肅宗 46年(1720)>

甘 字 番			
第二北犯參等裁直番	南北長陸拾參尺 東西廣貳拾伍尺	拾壹負	二方川南仲迪番 西世元番
起主			
舊任生			
今寺奴崔洪 □			

Table 5.is a part of Jeonan which was Kyungsangdo Namhaehyun Kyungja improvement. It uses Kamja meaning the character-number of the Thousand-Character Text, No.3, No.4, No.5, etc. for parcel number, Seobum and Dongbum for the direction of Yangjon, Samdeng and Sadeng for the grade of land, Jik for the form of land and dap for land category.

<Table 6> Kyungki-do Kwachon-kun Haseo-myun Yangan (Kwangmu 4 year-1900)

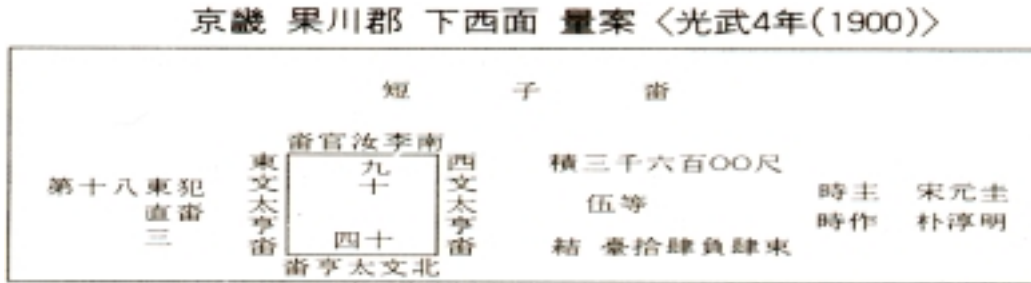

Table 6.is Yangan of Kyungkido Kwachonkun Haseomyun, and here Danja is character-number of the Thousand-Character Text and No.18 is parcel number.

In addition, land border in the four quarters was indicated by drawing four marks. 90 and 40 in the rectangle means that the length of land between south and north is 90 chuk and the width of land between east and west is 40 chuk. Yangjiomun was abolished on September 9, Kwangmu 1 year (1901) and Jikyeomun was established. In 'Daehanjekuk Jeondapkwanke', the character was used to indicate the parcel number.

There was the land report of group survey in each Dong and Ri and each parcel carried by investigation on land ownership of Chosun land survey as its major project. Character number in this report and Kyolsuyonmyungbu refer to parcel number and this character number is found in Wondojuksokillamdo numbering to each parcel in the survey. The first cadastral map was made in March, 1911 and thus the parcel number was recorded in the cadastral map for the first time. There is a record that people paid fees according to the parcel number when the first cadastral map was published in 1918. Also we can find the parcel number in forest survey document by Chosun Forest Survey in 1924.

3.2. The parcel number and its numbering system from the land survey to the present

The various forms of parcel number and its numbering system from the land survey in 1910 to the present are as follows in (table 7).

<Table.7> Historical form of parcel number and numbering system

Period	The parcel number from the land surveying after	The parcel number in 1960's	The parcel number in 1970's	The parcel number since 1986
The standard of the number	Jung, Ri, Dong or the area like this	Dong, Ri, street or the area like this	Dong, Ri, the area like this	
The composition of the parcel number	·Composing an original number compounding with chinese figures(,) vertically or attaching the mark to it ·Composing the mark to an original number compounding	·Composing an original number compounding with chinese figures(,) vertically or attaching the mark to it ·Composing the mark to an original number compounding with figures	·Composing the parcel number compounding with arabic figures horizontally or attaching subnumber to an original number ·Composing a subnumber compounding .-with	
A subnumber zone	·Subnumbering connected with the nearest map ·Subnumbering the land on the same map successively ·Subnumbering the parcel in the Gu successively if there are partitions like as road, river, stream, etc.	·Subnumbering connected with the nearest map ·Subnumbering the land on the same map successively ·Subnumbering the parcel in the Gu successively if there are partitions like as road, river, stream, etc.	·Subnumbering connected with the nearest map ·Subnumbering the land on the same map successively ·Subnumbering the parcel in the Gu successively if there are partitions like as road, river, stream, etc. on the	
The direction of subnumbering	·The northeast of the subnumbering zone the southwest ·Subnumbering meanderingly in the subnumbering zone ·Subnumbering alternately both side of lands	·The northeast of the subnumbering zone the southwest ·Subnumbering meanderingly in the subnumbering zone ·Subnumbering alternately the right side by on odd number, the left side by an even number on the street composed of Dong, Ri, road, etc. ·Subnumbering	·The northeast of the subnumbering zone the southwest ·Subnumbering meanderingly in the subnumbering zone ·Subnumbering alternately both side of lands on the street	·Numbering by northwest law granting the number from northwest to southwest as a unit of parcel number area

N u m b e r i n g o f t h e l a n d a l t e r a t i o n	P a r c e l n u m b e r o f d e v e l o p i n g	<p>·Subnumbering in order from the premier among the previous numbers in enforcement area</p> <p>·Attaching the mark to proper number among the previous ones in case the previous one is less than new one</p> <p>·Leaving the missing number as it is so as to chase the history of the land</p> <p>·Establishing the</p>	A c h a n g i n g z o n e o f a d m i n i s t r a t i o n	<p>·Writing down "officially to the new registered parcel number of Dong, Ri</p> <p>·Numbering orderly after the last number, in case the parcel number is complicated</p>	<p>·Numbering each land in order after reorganization setting the next number after the last parcel number as an original number</p> <p>·Numbering each land attaching the subnumber to an original number of the nearest land, in case the area is small or the number of the land with newly parcel number is few</p>	
			<p>·Numbering orderly from the premier among the previous parcel number, in case the parts of Dong, Ri, Ro are inserted</p> <p>·Using an original number in case the previous number can not be used due to partition and all the divided parcel number is within the area</p>	N u m b e r i n g o f a r r a n g i n g e n f o r c e m e n t l a n d s	<p>·Numbering with an original number only among the precious numbers after project enforcement</p> <p>·Granting one subnumber as a block unit when the previous number is more than new one, and subnumber to an original number to each parcel or numbering orderly setting the next number after the last one as an original one according to numbering system of new registration land</p> <p>·Numbering orderly form one area to the next area successively according to partitive area divided by important things</p> <p>·Not using an original number, in case the previous number is stretching over the border of the project enforcement area</p>	<p>·Numbering with an original number only among the previous numbers inserted within the project enforcement area</p> <p>·Numbering an original number with subnumber or an original number to each block unit and the original number with subnumber to each parcel, in case the previous number is less than a new number</p> <p>·Numbering according to the direction of the main road and subnumbering attaching to an original number of each land, in case the purpose of the project is housing manufacturing</p> <p>·Not using an original number when the previous one is stretching over the border of business enforcement area</p>

N u m b e r i n g o f t h e l a n d a l t e r a t i o n	New	<p>·Granting next number of the last one in case of attaching the mark to the one of the nearest land, when it is not around the last one</p> <p>·Subnumbering successively arranging part by the load, river stretching over all around the area, when new registration land is in a mass</p>	<p>·Numbering with mark to the nearest land</p> <p>·Numbering from the last number of corresponding Ri, when new registration land is in a mass more than 30 parcel number</p>	<p>·Attaching the mark "-1", "-2"</p> <p>·Numbering orderly from the last number as an original number in the relevant parcel number area, in case the nearest land is far away, and it corresponds or it is composed of several lands or vast area</p>	<p>·Attaching the subnumber like "-1", "-2" to the original number of the nearest registered land in relevant parcel number area, in case of a new registration, change of registration and parcel number and administration area</p>
	P a r t i t i o n l a n d	<p>·Attaching the mark to the parcel number before partition</p> <p>·Leaving the parcel number before partition when the mark is attached to an original number and making the mark orderly to each land according to the last number to an original number</p>	<p>·Attaching the mark to the parcel number before partition</p> <p>·Leaving the parcel number before partition when the mark is attached to an original number and making the mark orderly to each land according to the last number to an original number</p> <p>·Numbering can be done by applying number according to the state of a partition land</p> <p>·Marking the mark by top bottom, right left</p>	<p>·Attaching the mark to the parcel number before partition</p> <p>·Leaving the parcel number before partition when the mark is attached to an original number and making the mark orderly to each land according to the last number to an original number</p>	<p>·Numbering the same number to the one parcel of divided lands, and an original number with subnumber to the other parcel</p> <p>·Numbering the one which the owner wants within reason, when he applies for the special number of one land after partition</p>
	A f f i l i a t i o n l a n d	<p>·Numbering the premier before affiliation</p> <p>·Numbering an original number only in case of affiliating an original number with the parcel number with mark</p>	<p>·Numbering the premier before affiliation</p> <p>·Numbering an original number only in case of affiliating an original number with the parcel number with mark</p> <p>·Numbering the premier among the parcel numbers composing of the original numbers only</p>	<p>·Numbering the premier before affiliation</p> <p>·Numbering an original number only in case of affiliating an original number with the parcel number with mark</p> <p>·Numbering the one which the owner wants within reason</p>	<p>·Numbering the premier before affiliation</p> <p>·Numbering an original number only in case of affiliation</p> <p>·Granting the number which the owner wants within reason, when he applies for the special one before affiliation</p> <p>·The parcel number after affiliation should be granted as number 1, but the same number can be granted when the owner wants</p>

4. CONCLUSION

As a conclusion, the various types of parcel number and numbering system in Korea are summarized as follows.

1. The parcel number system with each Dong unit is proved as a unique type suitable to Korean environment which is consisted of 70% mountain area.
2. The parcel number and numbering system has changed according to the government policy and social environment. The problem is that unreasonable parcel number area could happen due to the taxation of local government and the change of administrative district.
3. The double parcel number method is a general rule, and short and long term of parcel number map should be made according to the increase of land use and the second sub-number should be considered. Only under this condition, the confusion of parcel number which possibly happens in the special city and metropolitan cities can be prevented in advance.
4. Analyzing historical change of the parcel number of Dong, we can know the process of developing of Dong.
5. It is desirable to revise the system of parcel number and numbering at minimum by the new project of parcel number only in complicated area. The place unit should be selected and maintained according to the emotion of Korean because the parcel number is used as an address in practice.

BIBLIOGRAPHY

1. Joongang Newspaper, 1996. National Cadastral Survey, 1996. 9. 11.
2. Kang Tae-Suk, Choi Yong-Kyu, Park Soon-Pyo, 1993. <General Study on Cadastral Survey>, Hyungseol Publishing Co., pp. 207-208, pp. 96-97.
3. Seoul City, 1993. <Cadastral Changes>, pp.259-260, p. 183.
4. Kim Uk-Nam, 1993. "Case Study of Parcel Number System and its Problems in New Cities", <Korean Cadastral Society>, Book 1, No. 1.
5. Kim Uk-Nam, Kwon Kyu-Tae, 1996. <Comparative Study on the parcel number and numbering system in established cities and new cities - focus on Sungnam City> Korean Cadastral Society 20th Anniversary Seminar, pp. 3-5, pp. 10-12.
6. Lee Kyu-Suk, Hwang Kuk-Young, "A Study on effective use of the parcel number in constructing land information system in Korea", Korean GIS Society 2 (1), pp. 85-92.
7. Won Young-Hee, 1979. <Principles of Cadastral Survey>, Hongik Publishing Co., p.109.
8. Won Young-Hee, 1980. <Korean History of Cadastral Survey>, pp. 475-476.
9. Kim Kap-Su, 1982. <General Study on Cadastral Administration>, Shilla Publishing Co., p. 50, pp. 58-59.
10. Yu Bok-Mo, 1994. <Topographical Information Study>, Dongmyung Publishing Co., p. 8, p. 519.
11. Korean Cadastral Society, 1996. <Collection of Cadastral Laws and Regulations>, Yangji-Sa.
12. Ministry of Home Affairs, 1987-1994. <Cadastral Statistics>.
13. <Sokdaejeon>, Hojeon, Yangjeonjo.

14. Kyujangkag Yangan, No. 147111.
15. Kyujangkag Old Document, No. 4258, pp. 5-10.
16. Dongah University Classic Research, 1982. <Translation and Annotation on Koryo History>, p. 342.
17. Henssen, 'Publicity and Speciality', p.1.
18. Henssen, 'The Significance and the Requirements of Land Registration and a Cadastre'.
19. Moyer, D.D., Fisher, K.J., 1973. 'Land Parcel Identifiers for Information System', American Bar Foundation, Chicago, pp. 51-64.
20. National Research Council, 1983. 'Need for a Multipurpose Cadastre' (National Academy Press), pp. 13-19.
21. Yang, In Tae & Kim, Uk-Nam, 1993. 'On the Application of Land Information System for the Land Management' IGARSS, p. 109.

CONTACT

Professor Uknam Kim
Dept. of Cadastral Registration
Shingu College
2685 Kumgwang Dong
Sunnam
Kyunggi
KOREA
Tel. + 82 31 740 1515
Fax + 82 31 740 1305
E-mail: Kun@ns.shingu-c.ac.kr