

LANDSCAPE IDENTITY  
RESOURCE

“Breccia Plaster” an identifying element of  
a landscape of the Sienese territory

Dott.Ing./J Geom. Emanuele Bossini

---

**-INTRODUCTION**

The potential of the professional association in the reading of the landscape

A reading of the Tuscan landscape

The complex St.M.Assunta di Rapolano Terme (SI)

Historical notes

The works

Rome May 2012

---





The complex St.M.Assunta in the heart of the village of Rapolano Terme

2

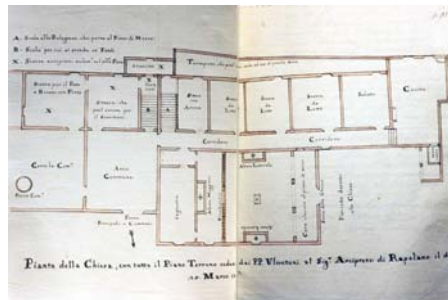
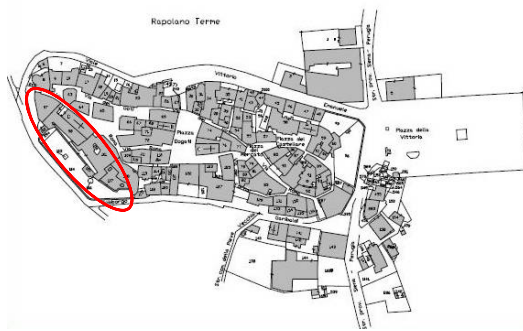

3

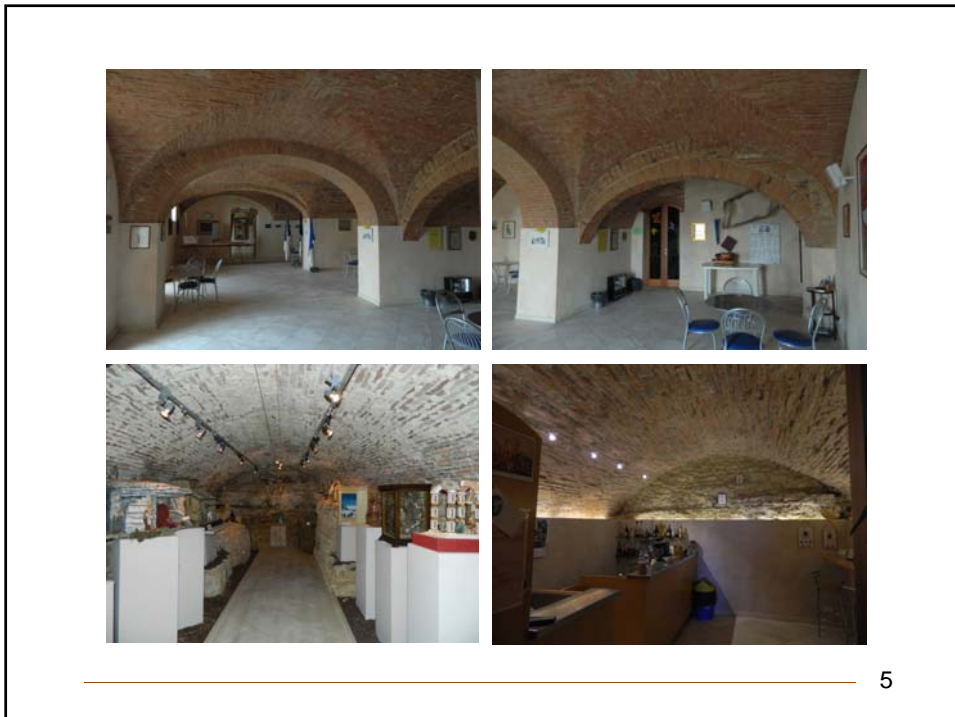
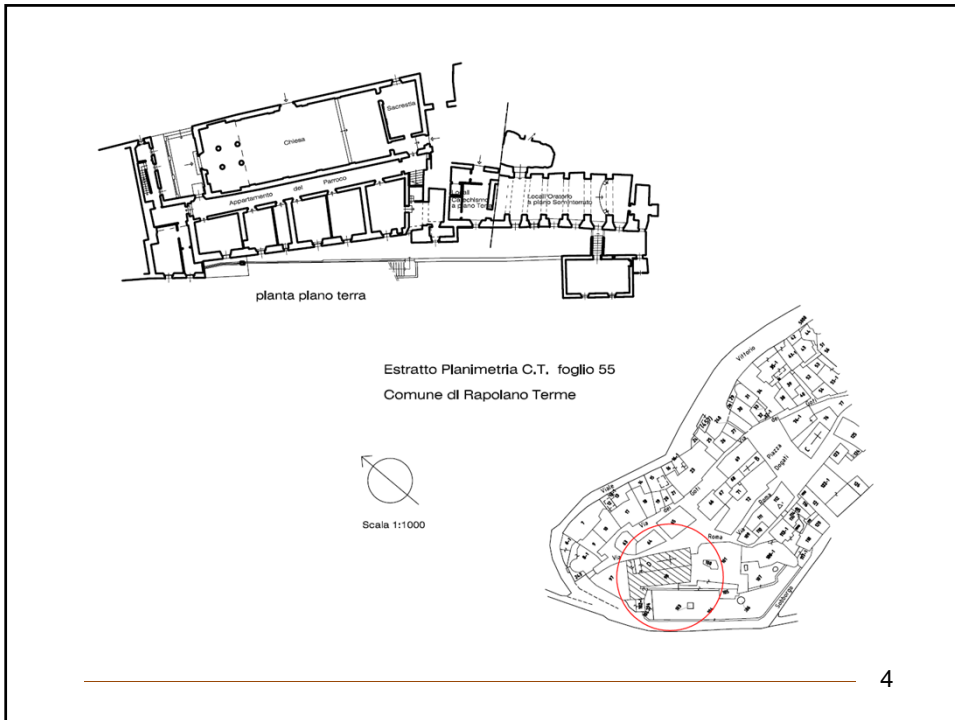

<p>LANDESCAPE IDENTITY RESOURCE</p> <p>“Breccia Plaster” an identifying element of a landscape of the Sienese territory</p> <p>Dott. Ing./J Geom. Emanuele Bossini</p>	<hr/> <p>-WORKS DESCRIPTON</p> <p>General considerations</p> <p>Detailed considerations</p> <p>Recognizing the identity of the medium</p> <p>Rome May 2012</p> <hr/>
--	--





The west front before restoration

8



The historic center seen from the "travertine strata" landscape

9



The historic center seen from the "travertine strata" landscape

10



Photos before restoration

11



12





14



15





16



17



18

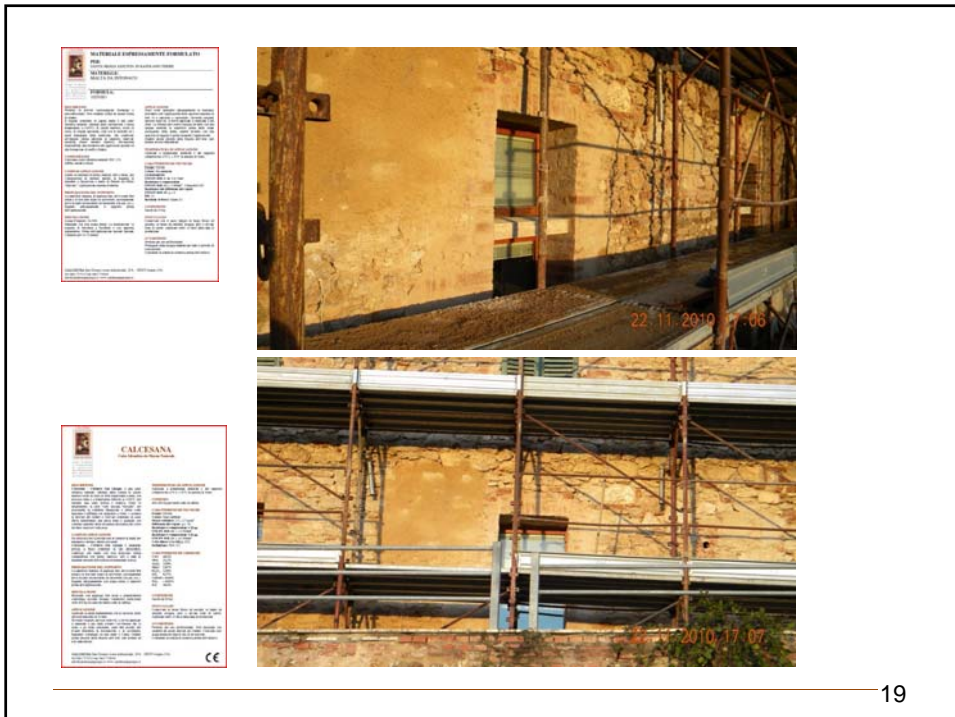

19



20



21



---

22



---

23



24



25



---

26



LANDSCAPE IDENTITY  
RESOURCES

"Breccia Plaster" an identifying element of  
A landscape of the Sienese territory

Dott. Ing./J Geom. Emanuele Bossini

---

-RECOGNIZING THE LANDSCAPE  
IDENTITY RESOURCES

Breccia Plaster an identifying element

A badly altered historic urban center

The quarries of breccia

Rapolano landscpaes

Conclusions

---

Rome May 2012



27



28

Comune di Espolino Terme  
 Piano Regolatore Generale  
**PIANO STRUTTURALE**  
 A.2.1a

29

CATEGORIA	SINTESI
AREE PROTETTE	...
AREE A RISCHIO	...
...	...

Comune di Espolino Terme  
 Piano Regolatore Generale  
**PIANO STRUTTURALE**  
 B.1.1

30





---

31



---

32



---

33



---

34



---

35



---

36



---

37



---

38







43



44

